



58 Castle Street, Maesteg, CF34 9YL

£90,000

We are pleased to offer For Sale this two bedroom semi detached property within close proximity to Maesteg Town Centre and all amenities and public transport links. The accommodation briefly comprises an entrance hall, lounge, kitchen/Diner, inner hall and wet room to the ground floor. Landing and two bedrooms to the first floor. The property further benefits from uPVC double glazing, gas central heating via combination boiler and enclosed rear garden.

The property requires a refurbishment and will make an ideal investment of first purchase.

Tenure = Freehold (TBC by a legal representative)

EPC = TBC

Council Tax Band = A

Ground Floor

Entrance Hall



Entry via a uPVC double glazed door, textured ceiling, papered walls, tiled flooring, radiator, carpeted staircase leading to the first floor, door into:-

Lounge 12'0" x 12'7" (3.68 x 3.86)



Textured and coved ceiling, skimmed and papered walls, fitted carpet, radiator, coal effect gas fire sitting on a tiled back and hearth with wooden mantle over, under stairs storage cupboard, uPVC double glazed window to the front, door into:-

Kitchen / Diner 16'3" x 8'6" (4.97 x 2.61)



Skimmed and coved ceiling, skimmed walls with tiled splash backs, tiled flooring, radiator, a range of base and wall mounted units with a complementary work surface housing a stainless steel sink/drainage, space for a freestanding oven, stainless steel chimney style extractor hood, space for a dining table, uPVC double glazed window to the rear, door into:-

Inner Hall 2'7" x 2'7" (0.80 x 0.81)



Textured ceiling, textured walls, tiled flooring, storage cupboard with textured ceiling and walls as well as fitted carpet - housing the gas combination boiler, uPVC double glazed door to the side providing access into the rear garden, door into:-

Wet Room 6'1" x 7'10" (1.86 x 2.39)



Textured ceiling, tiled walls, vinyl flooring, radiator, three piece suite comprising a wet room walk-in shower, wall mounted wash hand basin and a low level W.C., storage cupboard, uPVC double glazed window with obscured glass to the rear.

First Floor

Landing



Textured ceiling with loft access, papered walls, fitted carpet, two doors off:-

Bedroom One 15'2" x 12'9" (4.63 x 3.91)



Textured ceiling, papered walls, fitted carpet, radiator, built-in wardrobe, uPVC double glazed window to the front.

Bedroom Two 14'3" x 8'6" (4.36 x 2.61)



Textured ceiling, papered walls, fitted carpet, radiator, built-in wardrobe, uPVC double glazed window to the rear.

Outside

Rear Garden

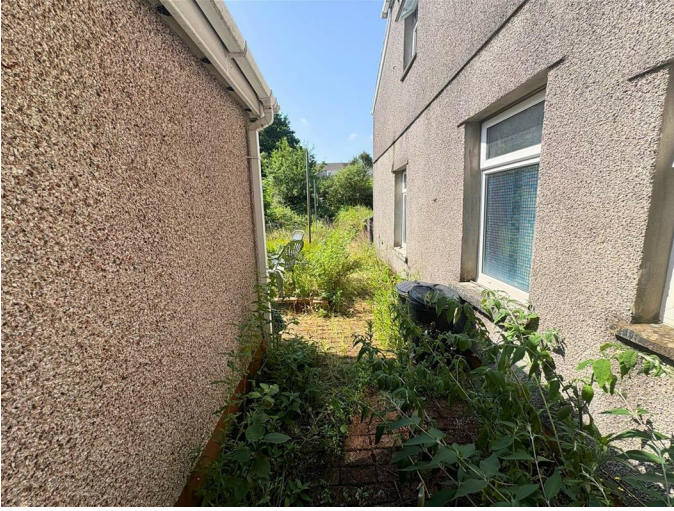

Garden overgrown and in need of attention.

Floor Plan

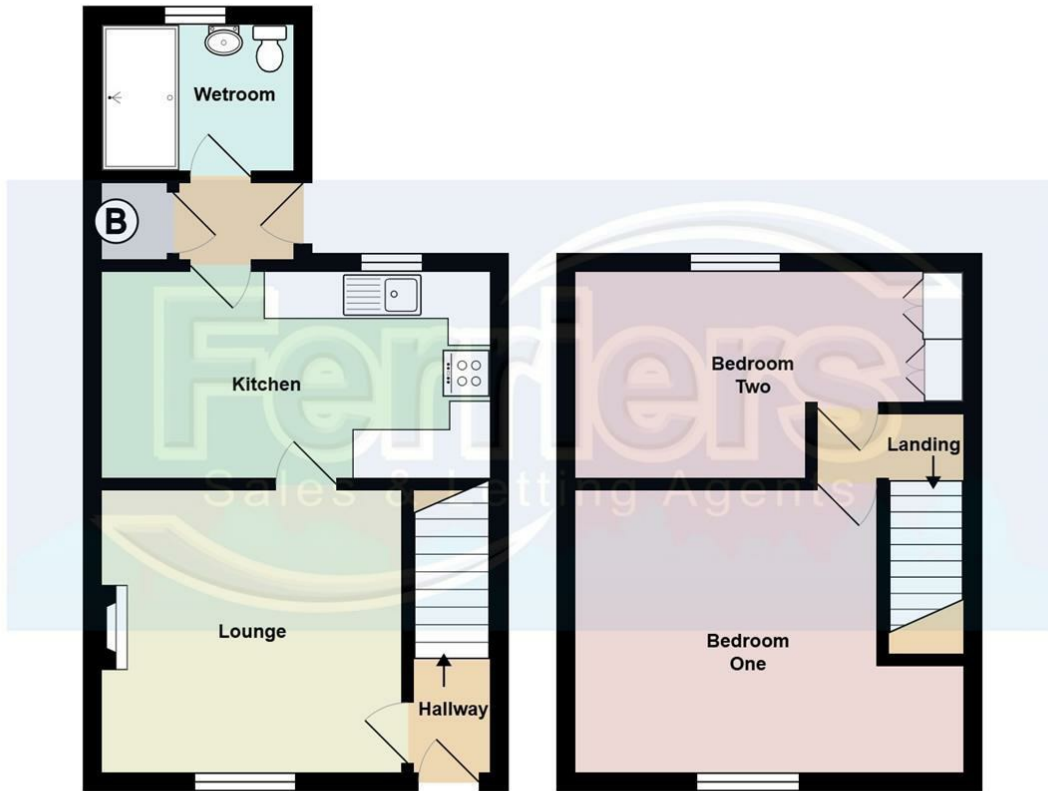

Area Map

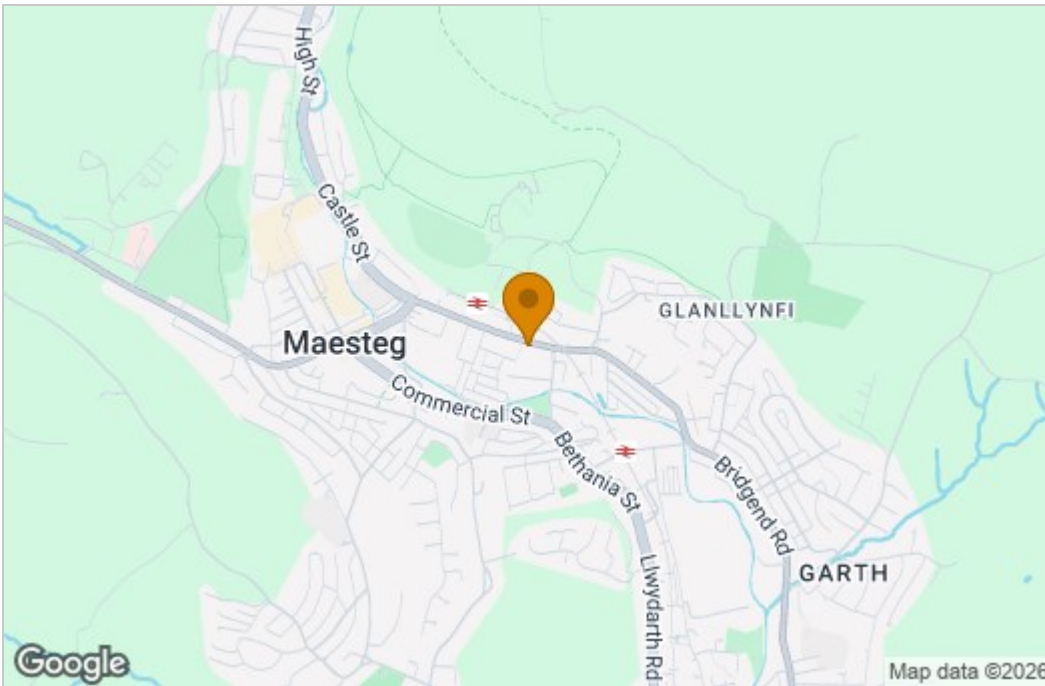

Energy Efficiency Graph

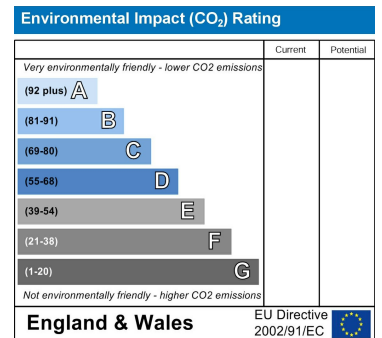
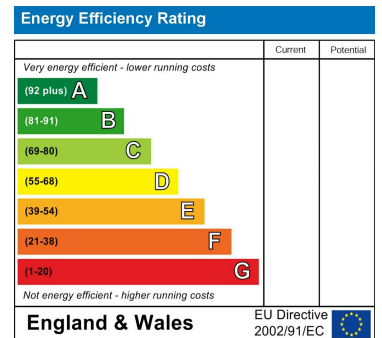

These particulars, whilst believed to be accurate are set out as a general outline only for guidance and do not constitute any part of an offer or contract. Intending purchasers should not rely on them as statements of representation of fact, but must satisfy themselves by inspection or otherwise as to their accuracy. No person in this firm's employment has the authority to make or give any representation or warranty in respect of the property.